

尖沙咀亞士厘道 29-39 號九龍中心 3 樓

3/F., Kowloon Centre, 29-33 Ashley Road, Tsim Sha Tsui



面積 **Gross area**: 約 **Approx. 16,375** 平方呎 **s.f.**
 管理費 **Management Fee**: **HK\$64,278.00/月** **Month**
 差餉 **Government Rate**: **HK\$56,000.00/季** **Quarter**
租金 Monthly Rent: HK\$450K (淨租金 Exclusive)
放售 For Sale: HK\$2.9 億/HK\$290M

地圖 Map:

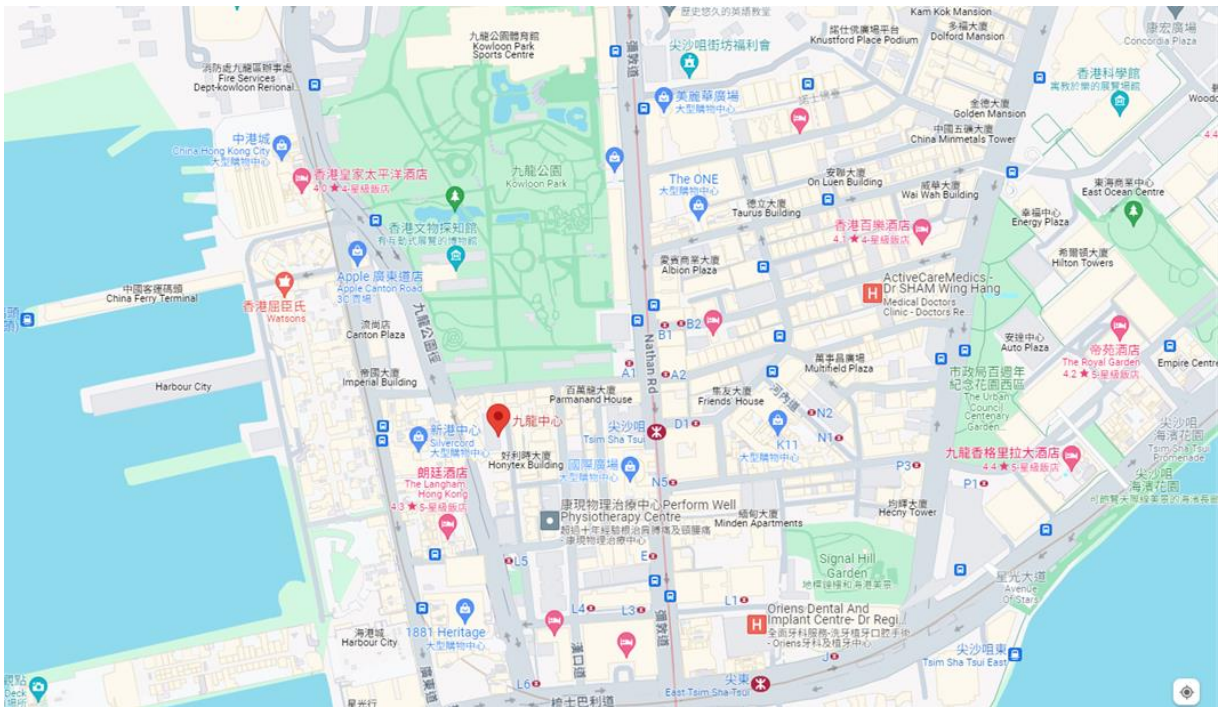

物業簡介 Introduction of the Premise:

- 位於尖沙咀亞士厘道，附近有多間餐廳
Located at Ashley Road in Tsim Sha Tsui, a lot of restaurants nearby
- 交通地點方便，鄰近尖沙咀站港鐵站
Convenient location, very close to Tsim Sha Tsui MTR station.

平面圖 Floor Plan (只供參考 Above Floor Plan is for reference only):

九龍中心3樓

尖沙咀亞士厘道29號

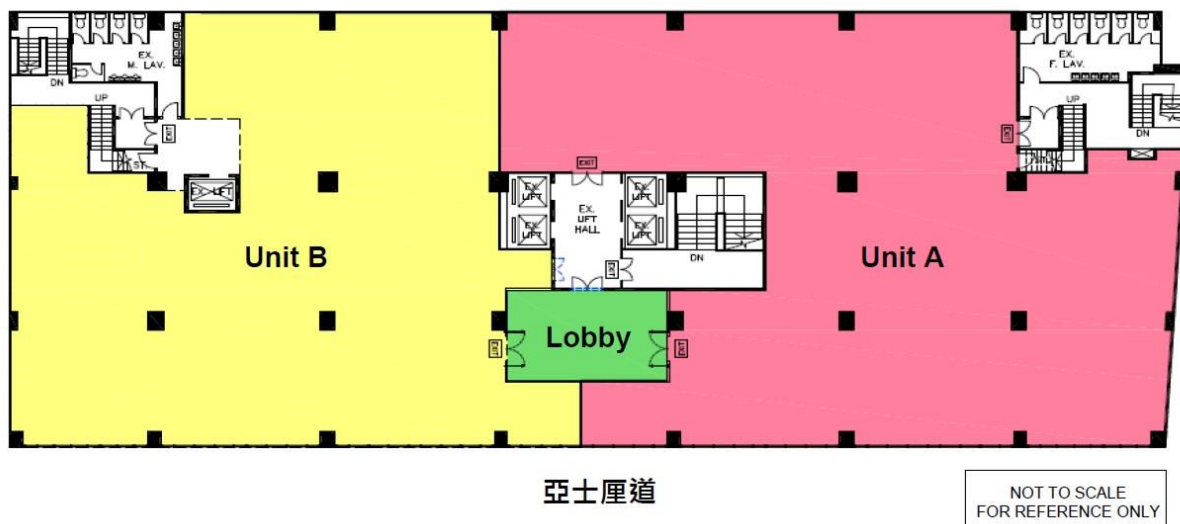

查詢: 2721 2727 Miss Kwok

刊登日期 Advertisement Date: 12-1-2024

物業編號 Property Number: TST/KC/3

Jan 2024